

Z.F.
Gearbox

95

CATALOGUE
Z.F.

FILE

95CBM013.pdf

SIZE

1,55MB

No. PAGES

15

RELEASE

02/2007

MODELS

OLD GENERATION 1268

S6-90/1 R.5,67-0,70

S6-90/1 R.6,37-0,82

S6-90/1 R.6,37-1,00

S6-90/1 R.6,98-1,00

S6-90/1 R.9,01-1,00

S6-90/1+GV90 R.6,98-0,82

S6-90/1+GV90 R.9,01-0,82

GROUP
Gearbox

Updated
2007

Options

ONLY FOR CD-ROM CATALOGUES



Home



Group



Back

%

Zoom
Select



Print



Page
Search



Catalogue
Search



Exit

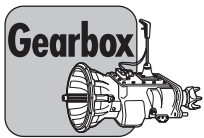

Input Shaft Technical Specification

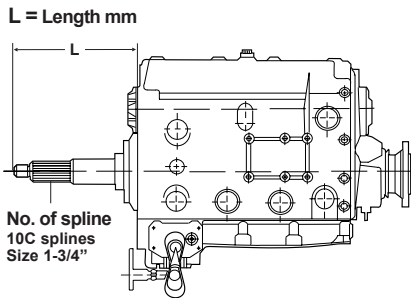

Front Cover Technical Specification

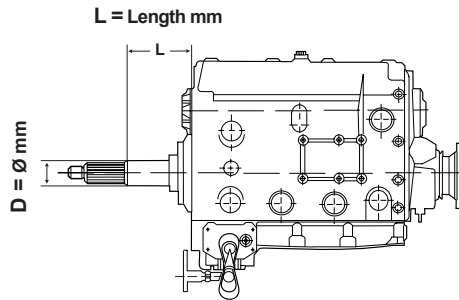

Tab 1 - Input Shaft Table

Our No.	TP	Input Shaft No.	Note	Ratio	Teeth	Sizes	Cover No.	Clutch Type
		1268 302 152	A	5,67-0,70	Z 33	L=260 SAE 10C 1-3/4"	1250 302 475	VALEO 430DTP
		1268 302 117	B	6,37-0,82		L=260 SAE 10C 1-3/4"	1250 302 144	
		1268 302 138	B	6,37-0,82		L=320 SAE 10C 1-3/4"	1246 302 089	DANA-SP. 1402SA
		1268 302 117	C	6,37-1,00		L=260 SAE 10C 1-3/4"	1250 302 144	F&S GMF420
95530250		1250 312 291	D	6,98-0,82	--	L=260 SAE 10C 1-3/4"	1250 302 144	
		1268 302 166	E	6,98-1,00	Z 28	L=320 SAE 10C 1-3/4"	1246 302 089	DANA-SP. 1402SA
		1268 302 168	F	6,98-1,00	Z 28	L=260 SAE 10C 1-3/4"	1250 302 144	
95530250		1250 312 291	G	9,01-0,82	--	L=260 SAE 10C 1-3/4"	1250 302 144	
95530315		1268 302 049	H	9,01-1,00	Z 25	L=260 SAE 10C 1-3/4"	1250 302 144	F&S GF420KR

Tab 2 - Front Cover Table

Fig.	Our No.	TP	Cover No.	Input Shaft No.	Note	Ratio	Sizes	Clutch Type
1			1250 302 475	1268 302 152	A	5,67-0,70	L=170 D=70	VALEO 430DTP
1	95530308		1250 302 144	1268 302 117	B	6,37-0,82	L=147 D=57	
				1268 302 117	C	6,37-1,00	L=147 D=57	F&S GMF420
				1250 312 291	D	6,98-0,82	L=147 D=57	
				1268 302 168	F	6,98-1,00	L=147 D=57	
				1250 312 291	G	9,01-0,82	L=147 D=57	
				1268 302 049	H	9,01-1,00	L=147 D=57	F&S GF420KR
2			1246 302 089	1268 302 138	B	6,37-0,82	L=82	DANA-SP. 1402SA
				1268 302 166	E	6,98-1,00	L=82	DANA-SP. 1402SA

Fig.	Our No.	Part No.	Description	Note	TP	A - R.5,67-0,70	B - R.6,37-0,82	C - R.6,37-1,00	D - R.6,98-0,82	EF - R.6,98-1,00	G - R.9,01-0,82	H - R.9,01-1,00						
1			SEE TAB 2 FRONT COVER															
2			SEE TAB 2 FRONT COVER															
3	95532902	1250 302 298	GASKET		■	■	■	■	■	■	■	■						
4	95531252	0734 310 108	SEAL RING 48X69X10		●	■	■	■	■	■	■	■						
5	95530304	1205 308 020	SPACER T.0,30 MM			■	■	■	■	■	■	■						
5	95530303	1205 308 016	SPACER T.0,20 MM			■	■	■	■	■	■	■						
6	95530286	0730 361 046	LOCK RING			■	■	■	■	■	■	■						
7	95570572	0730 103 510	SPLIT RING T.7,20 MM	OLD		■	■	■	■	■	■	■						
7		1499 298 093	SPLIT RING T.7,20 MM	NEW		■	■	■	■	■	■	■						
7		1499 298 092	SPLIT RING T.7,10 MM			■	■	■	■	■	■	■						
7	95530186	0730 102 629	SPLIT RING T.7,00 MM	OLD		■	■	■	■	■	■	■						
7		1499 298 045	SPLIT RING T.7,00 MM	NEW		■	■	■	■	■	■	■						
7	95530187	0730 102 630	SPLIT RING T.6,90 MM	OLD		■	■	■	■	■	■	■						
7		1499 298 046	SPLIT RING T.6,90 MM	NEW		■	■	■	■	■	■	■						
7	95530188	0730 102 631	SPLIT RING T.6,80 MM	OLD		■	■	■	■	■	■	■						
7		1499 298 047	SPLIT RING T.6,80 MM	NEW		■	■	■	■	■	■	■						
7	95530189	0730 102 632	SPLIT RING T.6,70 MM	OLD		■	■	■	■	■	■	■						
7		1499 298 048	SPLIT RING T.6,70 MM	NEW		■	■	■	■	■	■	■						
7		1499 298 137	SPLIT RING T.6,60 MM			■	■	■	■	■	■	■						
7		1499 298 138	SPLIT RING T.6,50 MM			■	■	■	■	■	■	■						
8	95531814	0630 503 020	LOCK RING		■	■	■	■	■	■	■	■						
9	98530079	0750 118 082	BEARING 70X150X35		●	■	■	■	■	■	■	■						
10		1268 302 152	INPUT SHAFT 33 T.	A		■												
10		1268 302 117	INPUT SHAFT 28 T.	BC			■	■										
10		1268 302 138	INPUT SHAFT 28 T.	B			■											
10		1268 302 166	INPUT SHAFT 28 T.	E					■									
10		1268 302 168	INPUT SHAFT 28 T.	F					■									
10	95530315	1268 302 049	INPUT SHAFT 25 T.	H							■							
11	95530304	1205 308 020	SPACER T.0,30 MM					■		■								
11		1205 308 040	SPACER T.0,25 MM					■		■								
11	95530303	1205 308 016	SPACER T.0,20 MM					■		■								
12	95532962	1250 312 253	DIAPHRAGM		■			■		■								
13	95531252	0734 310 108	SEAL RING 48X69X10		●			■		■								
14	95530286	0730 361 046	LOCK RING					■		■								
15	95570572	0730 103 510	SPLIT RING T.7,20 MM	OLD				■		■								

Notes / Note :

(From A to H) TO BE COUPLED TOGETHER
 (1) OLDEST TYPE 95530282 - 1240 304 384 - H 12,6 - WITHOUT STEP / NEW TYPE 95530563 - 1250 304 417 - H 17,4 - WITH 3 STEP
 OLDEST TYPE WITHOUT 3 HOLES FOR SPRING AS UNNECESSARY FOR GOOD SYNCHRONIZATION

Continued

Fig.	Our No.	Part No.	Description	Note	TP	A - R.5,67-0,70	B - R.6,37-0,82	C - R.6,37-1,00	D - R.6,98-0,82	EF - R.6,98-1,00	G - R.9,01-0,82	H - R.9,01-1,00							
15		1499 298 093	SPLIT RING T.7,20 MM	NEW															
15	95530186	0730 102 629	SPLIT RING T.7,00 MM	OLD															
15		1499 298 045	SPLIT RING T.7,00 MM	NEW															
15	95530187	0730 102 630	SPLIT RING T.6,90 MM	OLD															
15		1499 298 046	SPLIT RING T.6,90 MM	NEW															
15	95530188	0730 102 631	SPLIT RING T.6,80 MM	OLD															
15		1499 298 047	SPLIT RING T.6,80 MM	NEW															
15		1499 298 139	SPLIT RING T.6,40 MM																
16	<i>95531814</i>	0630 503 020	LOCK RING		■														
17	<i>98530078</i>	0750 118 081	BEARING 70X150X35		■														
18	95530250	1250 312 291	INPUT SHAFT GV																
19	98530070	0750 115 089	NEEDLE BEARING 68X74X45 W		●														
20	95530731	1268 312 010	GEAR 37 T. GV90																
20	95530208	1268 312 003	GEAR 31 T. GV90																
21	95530066	1250 312 366	SYNCHRONIZER CONE																
22	95530563	1250 304 417	SYNCHRONIZER RING																
22	95530282	1240 304 384	SYNCHRONIZER RING	OLD(1)															
23	95530065	1250 312 323	SYNCHRONIZER HUB																
24	95530026	1240 304 272	SLIDING SLEEVE																
25	95530067	1250 312 364	SYNCHRONIZER CONE																
26	95530100	1240 304 278	SLIDING BLOCK	3 PCS															
27	95530284	0732 040 386	SPRING	3 PCS															
28	95530270	0732 040 385	SPRING	3 PCS															
29		0630 501 044	SEEGER RING T.2,50 MM																
29		0630 531 322	SEEGER RING T.2,60 MM	OLD															
29		0730 501 237	SEEGER RING T.2,60	NEW															
30	95570098	0730 061 921	LOCK RING																
31	95570187	0730 102 989	SPLIT RING T.8,20 MM	OLD															
31		1499 298 058	SPLIT RING T.8,20 MM	NEW															
31	95570188	0730 104 269	SPLIT RING T.7,50 MM	OLD															
31		1499 298 113	SPLIT RING T.7,50 MM	NEW															
31	95530202	0730 102 995	SPACER T.7,00 MM	OLD															
31		1499 298 064	SPACER T.7,00 MM	NEW															
31	95570189	0730 102 998	SPLIT RING T.6,50 MM	OLD															
31		1499 298 067	SPLIT RING T.6,50 MM	NEW															

Notes / Note :

(From A to H) TO BE COUPLED TOGETHER
 (1) OLDEST TYPE 95530282 - 1240 304 384 - H 12,6 - WITHOUT STEP / NEW TYPE 95530563 - 1250 304 417 - H 17,4 - WITH 3 STEP
 OLDEST TYPE WITHOUT 3 HOLES FOR SPRING AS UNNECESSARY FOR GOOD SYNCHRONIZATION

Continued

Fig.	Our No.	Part No.	Description	Note	TP	A - R.5,67-0,70	B - R.6,37-0,82	C - R.6,37-1,00	D - R.6,98-0,82	EF - R.6,98-1,00	G - R.9,01-0,82	H - R.9,01-1,00						
31	95570190	0730 103 003	SPLIT RING T.6,00 MM	OLD					■	■								
31		1499 298 071	SPLIT RING T.6,00 MM	NEW 					■	■								
32		1268 212 039	FRONT BEARING COVER						■	■								
33		1250 312 473	GASKET						■	■								
34		0730 000 981	SPACER T.2,00 MM						■	■								
34		0730 000 796	SPACER T.1,00 MM						■	■								
35	95530303	1205 308 016	SPACER T.0,20 MM						■	■								
36	95531814	0630 503 020	LOCK RING		■				■	■								
37	98530079	0750 118 082	BEARING 70X150X35		●				■	■								
38	98530065	0735 358 032	NEEDLE BEARING 22X38X19		■				■	■								
39	95532194	0730 101 600	RING		■				■	■								
40	95570253	1268 312 142	INTERMEDIATE SHAFT 28 T.	D					■									
40	95530209	1268 312 005	INTERMEDIATE SHAFT 25 T.	G						■								
41	98530091	1269 298 951	BEARING 66,6X112,7X30,1		■				■	■								
42	95530770	1268 312 051	GEAR 50 T.	D					■									
42	95530210	1268 312 052	GEAR 54 T.	G						■								
43	98530054	0750 117 010	BEARING 50,8X100X35		●				■	■								
44	95530330	1268 312 057	SLIDE						■	■								
45		1229 206 027	SHIFT FORK GV						■									
45	95531429	1229 206 028	SHIFT FORK GV							■								
46	95531917	0634 310 011	OIL SEAL 25X35X7		■				■	■								
47		0734 319 237	OIL SEAL 25X35X10,5/7						■	■								
48	95532959	1250 312 211	BUSH		■				■	■								
49		1250 312 206	LEVER						■	■								
50	95570164	0750 132 009	CYLINDER		◆				■	■								
51	95531717	0630 501 024	SEEGER RING T.1,50 MM	ABCDEF	■	■	■	■	■	■								
51	95531840	0630 531 217	LOCK RING	GH	■					■	■							
52	98530302	0735 455 012	BEARING 30X68X26	ABCDEF	■	■	■	■	■	■								
52	98530058	0750 118 090	NEEDLE BEARING 30X60X28	GH	■					■	■							
53		0730 006 652	LOCK RING T.4,10 MM	ABCDEF		■	■	■	■	■								
53		0730 006 651	LOCK RING T.3,90 MM	ABCDEF		■	■	■	■	■								
53		0730 002 681	SHIM 3,70 MM	ABCDEF		■	■	■	■	■								
53		0730 002 682	SHIM 3,50 MM	ABCDEF		■	■	■	■	■								
53		0730 002 683	SHIM 3,30 MM	ABCDEF		■	■	■	■	■								
53		0730 006 650	LOCK RING T.3,10 MM	ABCDEF		■	■	■	■	■								

Notes / Note :

(From A to H) TO BE COUPLED TOGETHER
 (1) OLDEST TYPE 95530282 - 1240 304 384 - H 12,6 - WITHOUT STEP / NEW TYPE 95530563 - 1250 304 417 - H 17,4 - WITH 3 STEP
 OLDEST TYPE WITHOUT 3 HOLES FOR SPRING AS UNNECESSARY FOR GOOD SYNCHRONIZATION

Continued

Fig.	Our No.	Part No.	Description	Note	TP	A - R.5,67-0,70	B - R.6,37-0,82	C - R.6,37-1,00	D - R.6,98-0,82	EF - R.6,98-1,00	G - R.9,01-0,82	H - R.9,01-1,00						
53		0730 006 865	LOCK RING T.2,30 MM	ABCDEF		■	■	■	■	■								
53	95531301	0730 002 900	LOCK RING T.5,00 MM	GH	■						■	■						
53	95532064	0730 002 579	LOCK RING T.4,00 MM	GH	■						■	■						
53	95532065	0730 002 581	LOCK RING T.3,50 MM	GH	■						■	■						
53	95532066	0730 002 583	LOCK RING T.3,00 MM	GH	■						■	■						
53	95532136	0730 006 121	LOCK RING T.2,50 MM	GH	■						■	■						
54	95530923	0630 531 065	SEEGER RING T.3,00 MM	ABCDEF	■	■	■	■	■									
54	95530448	0630 501 114	SEEGER RING T.2,80 MM	ABCDEF	■	■	■	■	■									
54	95530627	0630 531 064	SEEGER RING T.2,50 MM	ABCDEF	■	■	■	■	■									
54	95530517	0630 501 148	SEEGER RING T.2,45 MM	ABCDEF	■	■	■	■	■									
54	95530513	0630 501 147	SEEGER RING T.2,30 MM	ABCDEF	■	■	■	■	■									
54	95570255	0630 531 057	SEEGER RING T.2,50 MM	GH	■						■	■						
54	95531842	0630 531 293	SEEGER RING T.2,40 MM	GH	■						■	■						
54		0630 531 294	SEEGER RING T.2,30 MM	GH							■	■						
54		0630 531 295	SEEGER RING T.2,20 MM	GH							■	■						
55		1268 304 446	SYNCHRONIZER CONE	ABC		■	■	■										
55		1268 304 540	SYNCHRONIZER CONE	DEF					■	■								
55		1246 304 377	SYNCHRONIZER CONE	GH							■	■						
56	95570573	1268 304 445	SYNCHRONIZER RING	OLD TYPE	◆	■	■	■	■	■	■	■						
56	95531073	1268 304 594	SYNCHRONIZER RING	NEW TYPE		■	■	■	■	■	■	■						
57		1268 304 528	SYNCHRONIZER HUB	ABCDEF		■	■	■	■	■								
57		1246 304 398	SYNCHRONIZER HUB	GH							■	■						
58	95570351	1304 304 597	SLIDING SLEEVE			■	■	■	■	■	■	■						
59		1268 304 506	SYNCHRONIZER CONE	ABC		■	■	■										
59		1268 304 541	SYNCHRONIZER CONE	DEF					■	■								
59		1246 304 376	SYNCHRONIZER CONE	GH							■	■						
60	95570574	1297 304 436	SLIDE	3 PCS		■	■	■	■	■	■	■						
61	95570470	0732 040 409	PRESSURE SPRING	3 PCS		■	■	■	■	■	■	■						
62		1268 304 349	GEAR 6TH SPEED 28 T.	A		■												
62		1268 304 281	GEAR 5TH SPEED 25 T.	B			■											
62	95530735	1268 304 247	GEAR 5TH SPEED 32 T.	C	◆			■										
62	95570151	1268 304 535	GEAR 5TH SPEED 32 T.	DF					■	■								
62	95530909	1268 304 536	GEAR 5TH SPEED 31 T.	E						■								
62	95530452	1268 304 287	GEAR 5TH SPEED 24 T.	G							■							
62	95530452	1268 304 287	GEAR 5TH SPEED 24 T.	H								■						

Notes / Note :

(From A to H) TO BE COUPLED TOGETHER
 (1) OLDEST TYPE 95530282 - 1240 304 384 - H 12,6 - WITHOUT STEP / NEW TYPE 95530563 - 1250 304 417 - H 17,4 - WITH 3 STEP
 OLDEST TYPE WITHOUT 3 HOLES FOR SPRING AS UNNECESSARY FOR GOOD SYNCHRONIZATION

Continued

Fig.	Our No.	Part No.	Description	Note	TP	A - R.5,67-0,70	B - R.6,37-0,82	C - R.6,37-1,00	D - R.6,98-0,82	EF - R.6,98-1,00	G - R.9,01-0,82	H - R.9,01-1,00						
63	98530044	0735 320 499	NEEDLE BEARING 62X70X40 W	ABCDEF	●	■	■	■	■	■								
63	98530066	0735 320 314	NEEDLE BEARING 58X64X43 W	GH	●						■	■						
64	95530736	1268 304 141	BUSH	ABCDEF		■	■	■	■	■								
64	95530046	1250 304 142	BUSH	GH							■	■						
65	95570344	1268 304 013	GEAR 4TH SPEED 33 T.	A		■												
65	95530387	1268 304 230	GEAR 4TH SPEED 29 T.	B			■											
65	95530737	1268 304 248	GEAR 4TH SPEED 32 T.	CDF				■	■	■								
65	95530746	1268 304 251	GEAR 4TH SPEED 31 T.	E						■								
65	95530084	1268 304 004	GEAR 4TH SPEED 29 T.	GH							■	■						
66	98530168	0750 115 284	NEEDLE BEARING 58X65X36 W		●	■	■	■	■	■	■	■						
67		1268 304 447	SYNCHRONIZER CONE			■	■	■	■	■	■	■						
68	95531735	0630 501 050	SEEGER RING T.2,50 MM		●	■	■	■	■	■	■	■						
68		0630 501 304	SEEGER RING T.2,20 MM			■	■	■	■	■	■	■						
69		1268 304 527	SYNCHRONIZER HUB			■	■	■	■	■	■	■						
70	95570351	1304 304 597	SLIDING SLEEVE			■	■	■	■	■	■	■						
71	95570345	1268 304 014	GEAR 3RD SPEED 38 T.	A		■												
71	95530438	1268 304 231	GEAR 3RD SPEED 33 T.	B			■											
71	95530741	1268 304 249	GEAR 3RD SPEED 35 T.	CDF				■	■	■								
71	95530747	1268 304 252	GEAR 3RD SPEED 35 T.	E						■								
71	95530083	1268 304 003	GEAR 3RD SPEED 35 T.	GH							■	■						
72	98530020	0750 115 134	NEEDLE BEARING 80X88X40		●	■	■	■	■	■	■	■						
73	95530742	1268 304 274	MAIN SHAFT 34 SPL.	ABCDEF		■	■	■	■	■								
73	95530463	1250 304 473	MAIN SHAFT 34 SPL.	GH							■	■						
74	98530048	0750 115 282	NEEDLE BEARING 95X103X40W		●	■	■	■	■	■	■	■						
75	95530480	1268 304 204	GEAR 2ND SPEED 42 T.	ABDEFGH		■	■		■	■	■	■						
75	95530743	1268 304 273	GEAR 2ND SPEED 43 T.	C				■										
76		1268 304 439	SYNCHRONIZER CONE			■	■	■	■	■	■	■						
77	95570217	1297 304 401	SYNCHRONIZER RING	OLD TYPE		■	■	■	■	■	■	■						
77	95531085	1297 304 485	SYNCHRONIZER RING	NEW TYPE		■	■	■	■	■	■	■						
78		1268 304 526	SYNCHRONIZER HUB			■	■	■	■	■	■	■						
79		1268 304 534	SLIDING SLEEVE			■	■	■	■	■	■	■						
80	95531736	0630 501 054	SEEGER RING T.3,00 MM		■	■	■	■	■	■	■	■						
80		0630 531 303	SEEGER RING T.2,80 MM			■	■	■	■	■	■	■						
81	98530042	0750 115 283	NEEDLE BEARING 80X88X46 W		●	■	■	■	■	■	■	■						
82	95530240	1268 304 256	GEAR 1ST SPEED 51 T.			■	■	■	■	■	■	■						

Notes / Note :

(From A to H) TO BE COUPLED TOGETHER
 (1) OLDEST TYPE 95530282 - 1240 304 384 - H 12,6 - WITHOUT STEP / NEW TYPE 95530563 - 1250 304 417 - H 17,4 - WITH 3 STEP
 OLDEST TYPE WITHOUT 3 HOLES FOR SPRING AS UNNECESSARY FOR GOOD SYNCHRONIZATION

Continued

Fig.	Our No.	Part No.	Description	Note	TP	A - R.5,67-0,70	B - R.6,37-0,82	C - R.6,37-1,00	D - R.6,98-0,82	EF - R.6,98-1,00	G - R.9,01-0,82	H - R.9,01-1,00							
83	95530040	1250 304 006	FOLLOWER RING			■	■	■	■	■	■	■							
84	95530019	0730 160 344	BUSH			■	■	■	■	■	■	■							
85	98530041	0735 320 154	NEEDLE BEARING 84X96X36		●	■	■	■	■	■	■	■							
86	95530087	1268 304 008	REVERSE GEAR 47 T.			■	■	■	■	■	■	■							
87	98530079	0750 118 082	BEARING 70X150X35	W/NEEDLE	●	■	■	■	■		■	■							
87	98530081	0635 333 049	BEARING 70X150X35	W/BALL	●						■	■							
88	95531814	0630 503 020	LOCK RING		■	■	■	■	■	■	■	■							
89	95570476	1268 306 101	SLIDING BLOCK		●	■	■	■	■	■	■	■							
90		1268 306 110	FORK	AB		■	■												
90	95570544	1250 306 262	SHIFT YOKE 4TH/5TH SPEED	CDEFGH				■	■	■	■	■							
91	95530105	1252 306 077	HEXAGON LOCATING BOLT			■	■	■	■	■	■	■							
92	95532301	0730 300 005	WASHER		■	■	■	■	■	■	■	■							
93	95570543	1246 206 011	FORK 2ND/3RD SPEED			■	■	■	■	■	■	■							
94	95530791	1240 306 229	SELECTOR ROD			■	■	■	■	■	■	■							
95	95531002	1268 206 041	SHIFT FORK		■	■	■	■	■	■	■	■							
96	95530792	1268 306 096	SELECTOR ROD			■	■	■	■	■	■	■							
97	95530794	1268 306 035	SLIDING FORK			■	■	■	■	■	■	■							
98	95531001	1246 206 008	SHIFT FORK			■	■	■	■	■	■	■							
99	95530790	1240 306 214	SELECTOR ROD	ABCDFGH		■	■	■	■	■	■	■							
99		1268 206 048	REVERSE SELECTOR ROD	E						■									
100		0730 002 667	SHIM 1,50 MM			■	■	■	■	■	■	■							
100		0730 002 672	SHIM 1,00 MM			■	■	■	■	■	■	■							
101	95533100	1268 308 020	GASKET		■	■	■	■	■	■	■	■							
102	95531314	1268 308 013	REAR COVER	BFGH	■		■			■	■	■							
102	95570567	1268 308 012	SPEEDO. COVER	DH				■				■							
103	95531254	0750 111 004	SEAL RING 85X105X10		●	■	■	■	■	■	■	■							
103		0734 310 131	OIL SEAL 100X120X10	W/RETARDER		■		■		■									
104	95531253	0750 110 074	SEAL RING 85X105X12		●	■	■	■	■	■	■	■							
104		0734 310 131	OIL SEAL 100X120X10	W/RETARDER		■		■		■									
105	95570186	1269 328 229	SPEEDOMETER GEAR 11 T.	ACE	■	■		■		■									
105		1250 304 197	SPEEDO PINION 11 T.	BDFGH			■		■	■	■	■							
106	95530175	1269 338 028	OUTPUT FLANGE			■	■	■	■	■	■	■							
106	95530174	1269 338 020	FLANGE D.180 - 10 HOLES			■	■	■	■	■	■	■							
106		1250 343 038	OUTPUT FLANGE	W/RETARDER		■	■	■	■	■	■	■							
106		1250 343 041	OUTPUT FLANGE	W/RETARDER		■	■	■	■	■	■	■							

Notes / Note :

(From A to H) TO BE COUPLED TOGETHER
 (1) OLDEST TYPE 95530282 - 1240 304 384 - H 12,6 - WITHOUT STEP / NEW TYPE 95530563 - 1250 304 417 - H 17,4 - WITH 3 STEP
 OLDEST TYPE WITHOUT 3 HOLES FOR SPRING AS UNNECESSARY FOR GOOD SYNCHRONIZATION

Continued

Fig.	Our No.	Part No.	Description	Note	TP	A - R.5,67-0,70	B - R.6,37-0,82	C - R.6,37-1,00	D - R.6,98-0,82	EF - R.6,98-1,00	G - R.9,01-0,82	H - R.9,01-1,00						
106		1250 343 045	OUTPUT FLANGE	W/RETARDER		■	■	■	■	■	■	■						
107	95530288	1240 304 117	SHIM			■	■	■	■	■	■	■						
107		1259 303 004	WASHER	W/RETARDER		■		■		■								
108		0636 016 012	SCREW M12X30			■	■	■	■	■	■	■						
108		0636 011 043	SCREW M12X95	W/RETARDER		■		■		■								
109	95531015	1250 304 353	SHEET STEEL		■	■	■	■	■	■	■	■						
110		1268 303 066	COVER			■	■	■	■	■	■	■						
111	95533066	1268 303 132	GASKET		■	■	■	■	■	■	■	■						
112		0730 103 122	SHIM 3,50 MM			■	■	■	■	■	■	■						
112		0730 102 099	SHIM 3,00 MM			■	■	■	■	■	■	■						
112		0730 102 062	SHIM 2,50 MM			■	■	■	■	■	■	■						
112		0730 102 072	SHIM 2,00 MM			■	■	■	■	■	■	■						
113	95530923	0630 531 065	SEEGER RING T.3,00 MM		■	■	■	■	■	■	■	■						
113	95530448	0630 501 114	SEEGER RING T.2,80 MM		■	■	■	■	■	■	■	■						
113	95530627	0630 531 064	SEEGER RING T.2,50 MM		■	■	■	■	■	■	■	■						
113	95530517	0630 501 148	SEEGER RING T.2,45 MM		■	■	■	■	■	■	■	■						
113	95530513	0630 501 147	SEEGER RING T.2,30 MM		■	■	■	■	■	■	■	■						
114	98530054	0750 117 010	BEARING 50,8X100X35		●	■	■	■	■	■	■	■						
115	95570346	1268 303 059	CONSTANT GEAR 44 T.	A		■												
115	95530297	1268 303 084	CONSTANT GEAR 42 T.	BC			■	■										
115	95530874	1268 303 093	CONSTANT GEAR 46 T.	DEF					■	■								
115	95530077	1268 303 056	CONSTANT GEAR 53 T.	GH							■	■						
116	95570347	1268 303 010	GEAR 5TH SPEED 53 T.	A		■												
116	95530321	1268 303 085	GEAR 5TH SPEED 46 T.	B			■											
116	95530739	1268 303 094	GEAR 5TH SPEED 37 T.	CDF				■	■	■								
116	95530748	1268 303 096	GEAR 5TH SPEED 39 T.	E						■								
116	95530078	1268 303 004	GEAR 5TH SPEED 34 T.	GH							■	■						
117	95570348	1268 303 011	DOUBLE GEAR 23/30 T.	A		■												
117	95530322	1268 303 086	DOUBLE GEAR 32/23 T.	B			■											
117	95530740	1268 303 095	DOUBLE GEAR 20/26 T.	CDF				■	■	■								
117	95530749	1268 303 097	DOUBLE GEAR 3RD/4TH 21/27	E						■								
117	95530079	1268 303 005	DOUBLE GEAR 23/28 T.	GH							■	■						
118	95530098	1268 203 001	COUNTERSHAFT 12/17 T.	ABDEFGH		■	■		■	■	■	■						
118		1268 203 061	COUNTERSHAFT	C				■										
119	98530095	0750 117 778	BEARING 45X100X38,25		●	■	■	■	■	■	■	■						

Notes / Note :

(From A to H) TO BE COUPLED TOGETHER
 (1) OLDEST TYPE 95530282 - 1240 304 384 - H 12,6 - WITHOUT STEP / NEW TYPE 95530563 - 1250 304 417 - H 17,4 - WITH 3 STEP
 OLDEST TYPE WITHOUT 3 HOLES FOR SPRING AS UNNECESSARY FOR GOOD SYNCHRONIZATION

Continued

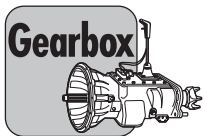

S6-90/1 / S6-90/1+GV90 Selector Mechanism

Fig.	Our No.	Part No.	TP	Description	Note
1		1268 307 175		LEVER	
1		1250 307 666		LEVER	
2	95532736	1238 307 411	■	COVER	
3	95532761	1240 307 434		ROD	(A)
3	95531287	1240 307 433		SELECTOR ROD	(B)
4	95531306	0735 470 007	●	PIN	
5		1268 307 155		DRIVER	
6	95531257	1240 307 338		DRIVER	
7		0730 061 091		RING	
7		0730 061 092		RING	
8	95532757	1240 307 374	■	DRIVER	
9		0631 329 072		PIN	
10		0631 329 145		PIN	
11		1268 307 172		DRIVER	
12	95531402	1250 307 601		PIN	
13	95530307	0732 040 554		SPRING	
14	95532236	0730 104 083	■	WASHER	
15		1204 307 030		SPRING	(A)
15		0732 040 022		PRESSURE SPRING	(B)
16	95532382	0732 040 765	■	PRESSURE SPRING	(A)
16		0732 040 237		PRESSURE SPRING	(B)
17		0730 001 156		WASHER	
18		0630 532 138		RING	
19	95532756	1240 307 339		DRIVER	

Notes:
(AB) To be coupled together

Fig.	Our No.	Part No.	TP	Description	Note
1	95530309	1240 307 346		PIN	
2	95531248	0634 307 367	●	OIL SEAL 25X35X7/10	
3	95531247	0634 300 302	●	OIL SEAL 25X35X7	
4	95570501	0730 260 330		BUSH	(1)
5	95531870	0634 300 020	●	OIL SEAL 25X32X5	(1)
6	95532945	1250 307 652	■	COVER	
6	95532760	1240 307 431	■	COVER	
7	95530305	1252 307 068	◆	GASKET	
8	98530219	0635 303 053	■	BEARING 25X32X20	
9	95530305	1252 307 068	◆	GASKET	
10		1240 307 480		COVER	
10		1240 307 424		COVER	
11	95532933	1250 306 282	■	GASKET	
12		1250 307 450		COVER	
12		1250 307 613		COVER	

Note:
(1) Only for 1240 307 431

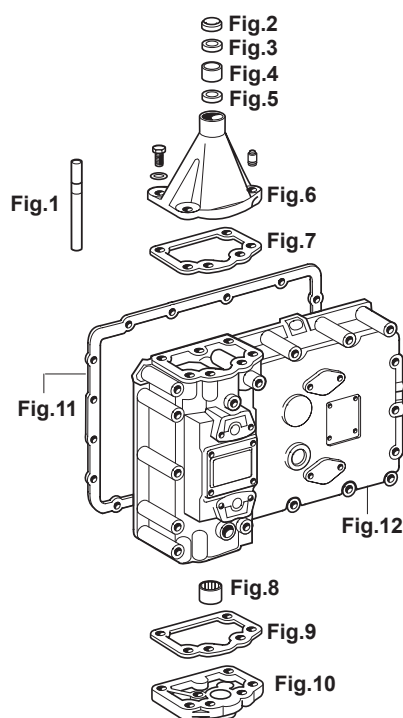
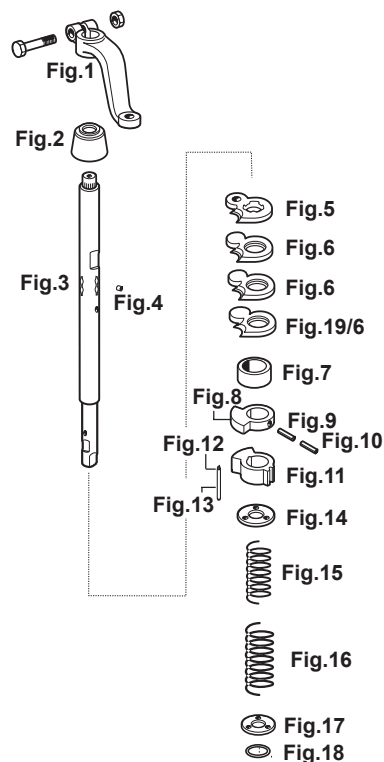

S6-90/1 / S6-90/1+GV90 Selector Mechanism

Fig.	Our No.	Part No.	TP	Description	Note
1	95531280	0501 204 714	●	BALL JOINT M14X1,5 RH	L=85 MM
2		0637 006 180		NUT	M14
3		0637 011 570		NUT	M10
4	95531251	0732 107 019	●	BALL JOINT M12X1,75 LF	L=55 MM
5		0637 006 215		NUT	M12
6		0736 620 061		ROD	
7	95532037	0637 006 202	■	NUT	M12
8	95531279	0732 107 018	●	BALL JOINT M12X1,75 RH	L=55 MM

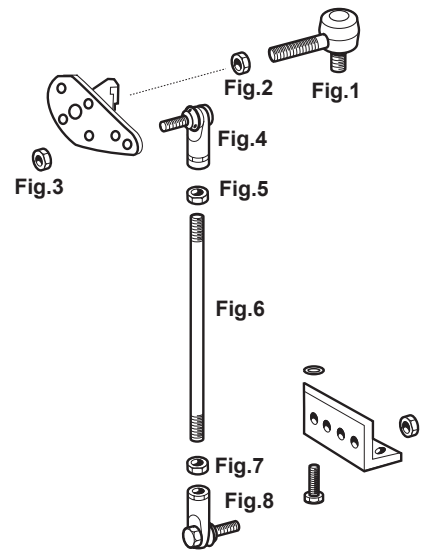

S6-90/1 / S6-90/1+GV90 Kits

Fig.	Our No.	Part No.	TP	Description	Q.ty
	95570387	1269 212 016		SYNCHRONIZER KIT	
1	95530563	1250 304 417		SYNCHRONIZER RING	2 pcs.
2	95530065	1250 312 323		SYNCHRONIZER HUB	1 pc.
3	95530026	1240 304 272		SLIDING SLEEVE	1 pc.
4	95570661	1268 298 938		REPAIR KIT	1 pc.

Fig.	Our No.	Part No.	TP	Description	Q.ty
		1268 298 959		SYNCHRONIZER KIT	
1	95530066	1250 312 366		SYNCHRONIZER CONE	1 pc.
2	95530563	1250 304 417		SYNCHRONIZER RING	2 pcs.
3	95530026	1240 304 272		SLIDING SLEEVE	1 pc.
4	95530065	1250 312 323		SYNCHRONIZER HUB	1 pc.
5	95530067	1250 312 364		SYNCHRONIZER CONE	1 pc.
6	95530100	1240 304 278		SLIDING BLOCK	3 pcs.
7	95530284	0732 040 386		SPRING	3 pcs.
8	95530270	0732 040 385		SPRING	3 pcs.

Fig.	Our No.	Part No.	TP	Description	Q.ty
	95534271	1268 298 967		SYNCHRONIZER KIT	
1	95530066	1250 312 366		SYNCHRONIZER CONE	1 pc.
2	95530563	1250 304 417		SYNCHRONIZER RING	2 pcs.
3	95530026	1240 304 272		SLIDING SLEEVE	1 pc.
4	95570661	1268 298 938		REPAIR KIT	1 pc.
5	95530067	1250 312 364		SYNCHRONIZER CONE	1 pc.

Fig.	Our No.	Part No.	TP	Description	Q.ty
	95570389	1268 298 939		SYNCHRONIZER KIT	
1	95530066	1250 312 366		SYNCHRONIZER CONE	1 pc.
2	95530563	1250 304 417		SYNCHRONIZER RING	2 pcs.
3	95530067	1250 312 364		SYNCHRONIZER CONE	1 pc.
4	95570661	1268 298 938		REPAIR KIT	1 pc.

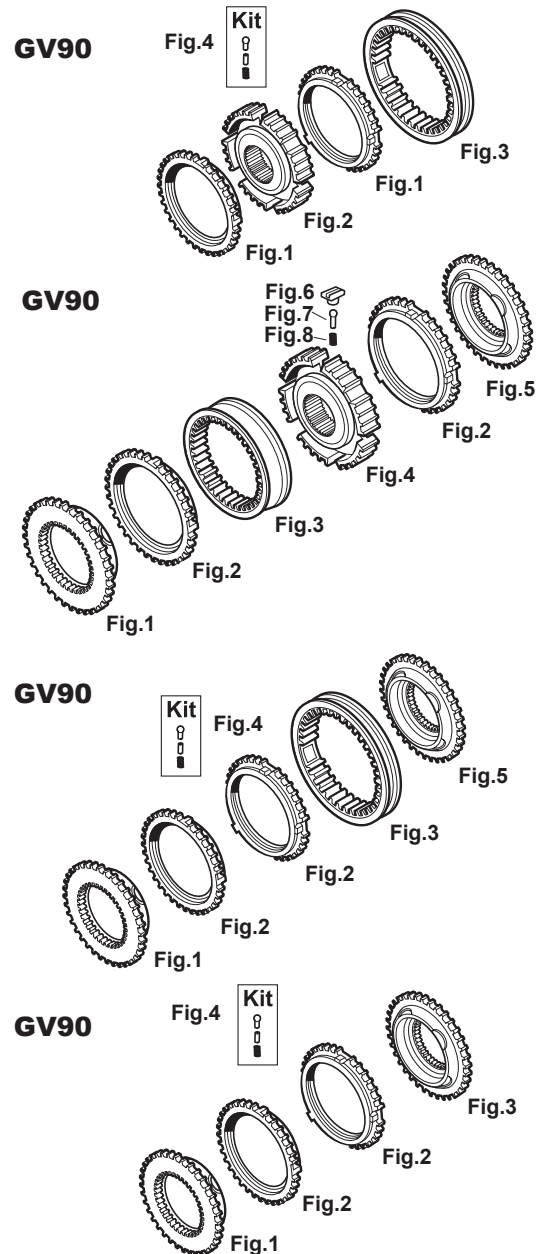

Our Parts are not original but perfectly interchangeable with the O.E.M ones. All original equipment manufacturers' names, numbers, symbols and descriptions used in this catalogue are for reference purposes only.
Tutti i nostri particolari non sono originali ma con essi intercambiabili. Tutti i riferimenti dei costruttori originali sono usati a semplice titolo indicativo.



S6-90/1 / S6-90/1+GV90 Kits

Fig.	Our No.	Part No.	TP	Description	Q.ty
		1268 204 075		SYNCHRONIZER KIT	
1	95531073	1268 304 594		SYNCHRONIZER RING	2 pcs.
2		1268 304 528		SYNCHRONIZER HUB	1 pc.
3	95570351	1304 304 597		SLIDING SLEEVE	1 pc.
4	95570574	1297 304 436		SLIDE	3 pcs.
5	95570470	0732 040 409		PRESSURE SPRING	3 pcs.

Fig.	Our No.	Part No.	TP	Description	Q.ty
		1268 298 956		SYNCHRONIZER KIT	
1		1268 304 446		SYNCHRONIZER CONE	1 pc.
2	95531073	1268 304 594		SYNCHRONIZER RING	2 pcs.
3		1268 304 528		SYNCHRONIZER HUB	1 pc.
4	95570351	1304 304 597		SLIDING SLEEVE	1 pc.
5		1268 304 506		SYNCHRONIZER CONE	1 pc.
6	95570574	1297 304 436		SLIDE	3 pcs.
7	95570470	0732 040 409		PRESSURE SPRING	3 pcs.

Fig.	Our No.	Part No.	TP	Description	Q.ty
		1250 204 083		SYNCHRONIZER KIT 5TH/6TH	
1	95531073	1268 304 594		SYNCHRONIZER RING	2 pcs.
2		1246 304 398		SYNCHRONIZER HUB	1 pc.
3	95570351	1304 304 597		SLIDING SLEEVE	1 pc.
4	95570574	1297 304 436		SLIDE	3 pcs.
5	95570470	0732 040 409		PRESSURE SPRING	3 pcs.

Fig.	Our No.	Part No.	TP	Description	Q.ty
		1268 204 077		SYNCHRONIZER KIT 3RD/4TH	
1	95531073	1268 304 594		SYNCHRONIZER RING	2 pcs.
2		1268 304 527		SYNCHRONIZER HUB	1 pc.
3	95570351	1304 304 597		SLIDING SLEEVE	1 pc.
4	95570574	1297 304 436		SLIDE	3 pcs.
5	95570470	0732 040 409		PRESSURE SPRING	3 pcs.

Fig.	Our No.	Part No.	TP	Description	Q.ty
		1268 204 076		SYNCHRONIZER KIT 1ST/2ND	
1	95531085	1297 304 485		SYNCHRONIZER RING	2 pcs.
2		1268 304 526		SYNCHRONIZER HUB	1 pc.
3		1268 304 534		SLIDING SLEEVE	1 pc.
4	95570574	1297 304 436		SLIDE	3 pcs.
5	95570470	0732 040 409		PRESSURE SPRING	3 pcs.

Fig.	Our No.	Part No.	TP	Description	Q.ty
		1268 298 957		SYNCHRONIZER KIT 1ST/2ND	
1		1268 304 439		SYNCHRONIZER CONE	2 pcs.
2	95531085	1297 304 485		SYNCHRONIZER RING	2 pcs.
3		1268 304 526		SYNCHRONIZER HUB	1 pc.
4		1268 304 534		SLIDING SLEEVE	1 pc.
5	95570574	1297 304 436		SLIDE	3 pcs.
6	95570470	0732 040 409		PRESSURE SPRING	3 pcs.

5th/6th
Excl. Note
GH

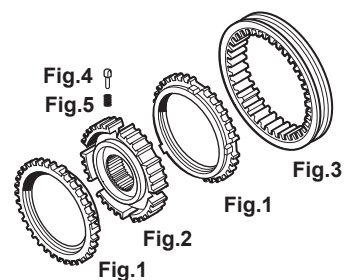

5th/6th
Excl. Note
GH

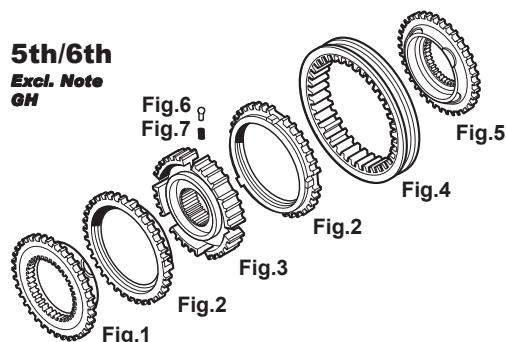

5th/6th
Only Note
GH

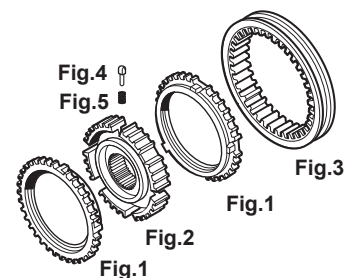

3rd/4th

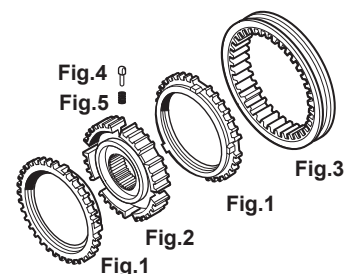

1st/2nd

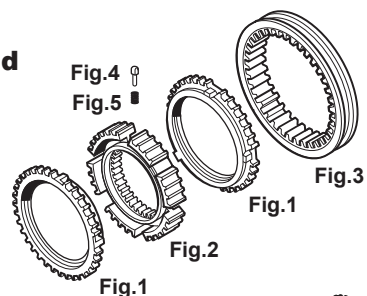

1st/2nd

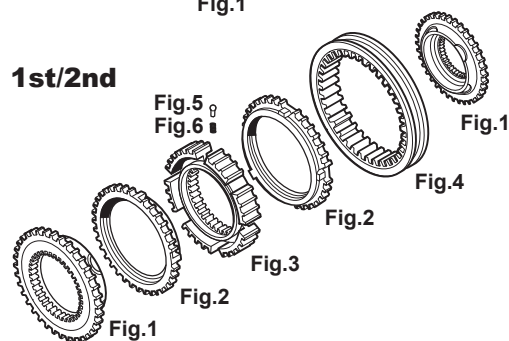

OPTIONS



S6-90/1 / S6-90/1+GV90 Kits

Fig.	Our No.	Part No.	TP	Description	Q.ty
	95531311	1268 298 933	■	BEARINGS KIT	
1	98530054	0750 117 010	●	BEARING 50,8X100X35	1 pc.
2	98530091	1269 298 951	■	BEARING 66,6X112,7X30,1	1 pc.
3	98530079	0750 118 082	●	BEARING 70X150X35	1 pc.
4	98530065	0735 358 032	■	NEEDLE BEARING 22X38X19	1 pc.
5	98530078	0750 118 081	■	BEARING 70X150X35	1 pc.
6	98530070	0750 115 089	●	NEEDLE BEARING 68X74X45 W	1 pc.

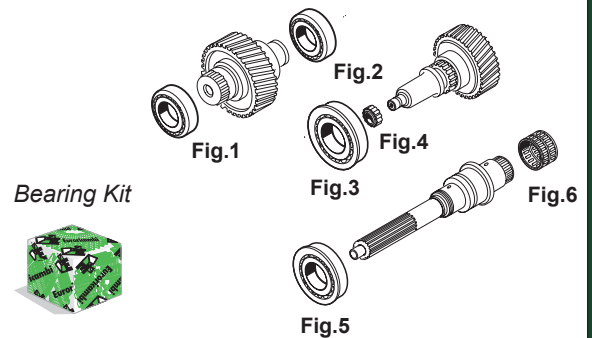

Fig.	Our No.	Part No.	TP	Description	Q.ty
		1268 298 934		BEARING KIT	
1	98530079	0750 118 082	●	BEARING 70X150X35	1 pc.
2	98530058	0750 118 090	■	NEEDLE BEARING 30X60X28	1 pc.
3	98530081	0635 333 049	●	BEARING 70X150X35	1 pc.
4	98530054	0750 117 010	●	BEARING 50,8X100X35	1 pc.
5	98530095	0750 117 778	●	BEARING 45X100X38,25	1 pc.

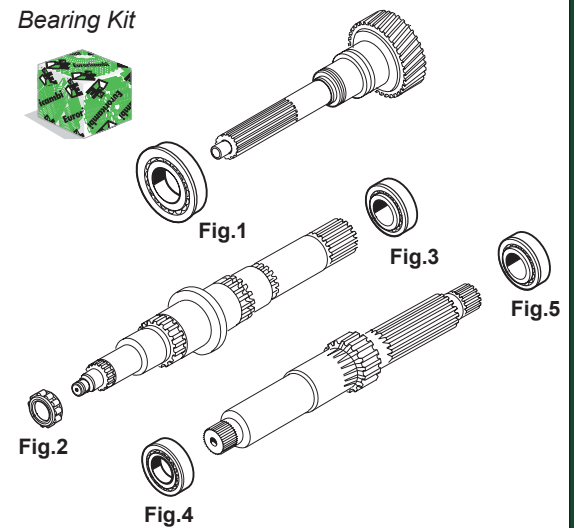

Fig.	Our No.	Part No.	TP	Description	Q.ty
	98530316	1268 298 936	●	NEEDLE BEARINGS KIT	
	98530066	0735 320 314	●	NEEDLE BEARING 58X64X43 W	1 pc.
	98530168	0750 115 284	●	NEEDLE BEARING 58X65X36 W	1 pc.
	98530020	0750 115 134	●	NEEDLE BEARING 80X88X40	1 pc.
	98530048	0750 115 282	●	NEEDLE BEARING 95X103X40W	1 pc.
	98530042	0750 115 283	●	NEEDLE BEARING 80X88X46 W	1 pc.
	98530041	0735 320 154	●	NEEDLE BEARING 84X96X36	1 pc.
	98530035	0750 115 011	●	NEEDLE BEARING 45X53X21	2 pcs.
	98530071	0750 118 019	●	BEARING 30X60X26	1 pc.

98530316
1268 298 936
Needle Bearings Kit

