

SCANIA

Truck and Bus

74

CATALOGUE
SCANIA

FILE

74CBM006.pdf

SIZE

1,20MB

No. PAGES

8

RELEASE

07/2006

MODELS

GR 880

GR 880T

GRH 880

GROUP

Gearbox

Updated
2006

EURORICAMBI manufactures replacement gears and bevel gears & pinions suitable to gearboxes and differentials of several marks of vehicles, such as: DAF, EATON, FULLER, FORD,

Options

ONLY FOR CD-ROM CATALOGUES



Home



Group



Back

%

Zoom
Select



Print



Page
Search



Catalogue
Search



Exit



GEARBOX CAMBIO

Models / Modelli	
GR 880	
GR 880T	
GRH 880	



Oil Pump
(fig. 174)

Latest
Execution

Kit
171

KIT
175 = □

New Style
12 Fins

Old Style
4 Fins

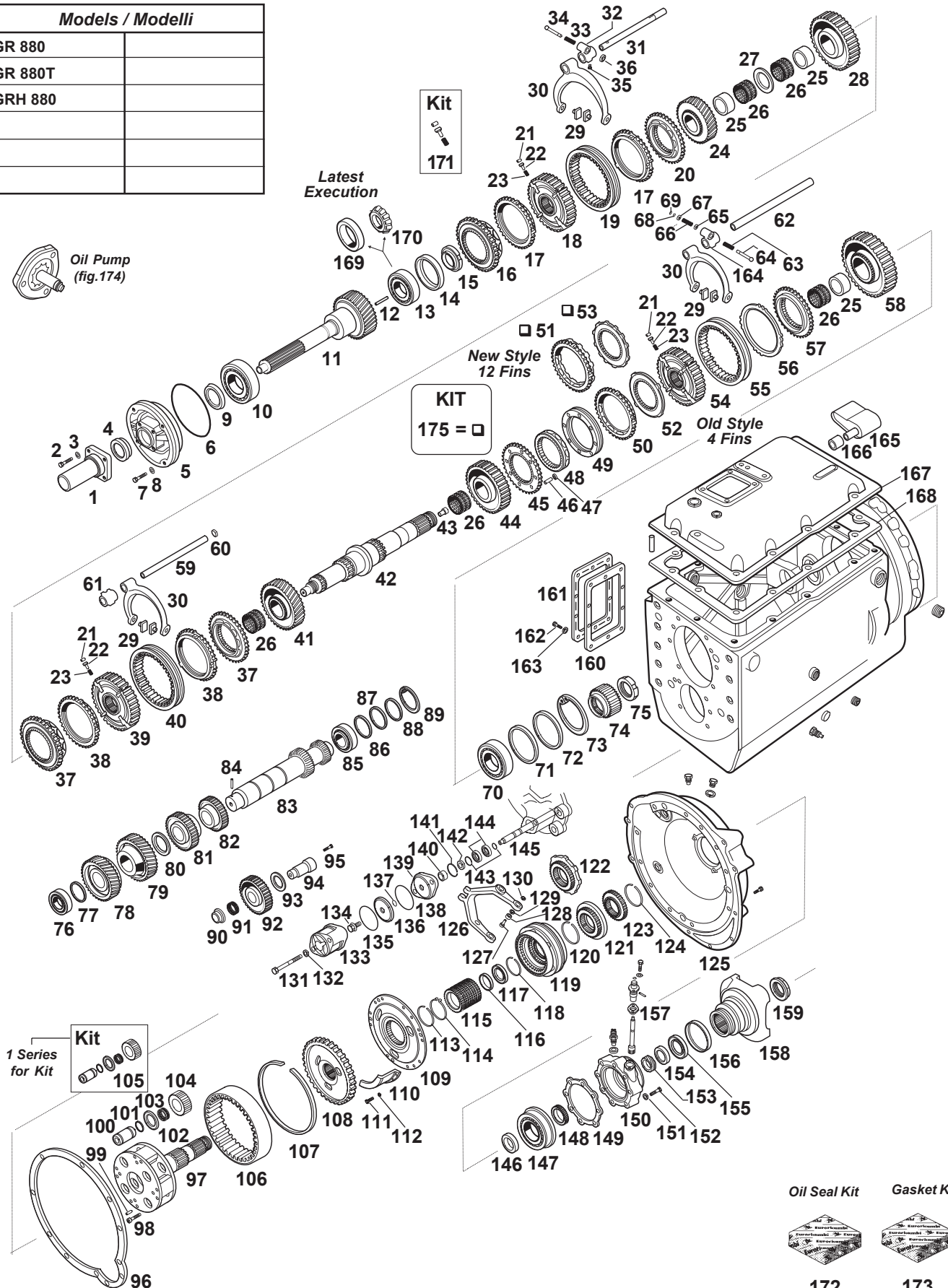

1 Series
for Kit

Kit
105 104 103 102 101 100 99

Oil Seal Kit

Gasket Kit



172

173



OPTIONS

Fig.	Our No.	Part No. Description	Note	TP	GR 880	GR 880T	GRH 880													
1	74520018	1103 619 FRONT BEARING COVER			■	■	■													
2		808 295 SCREW M8X22	4 PCS		■	■	■													
3		802 998 WASHER 8,4X16X1,6	4 PCS		■	■	■													
4	74530256	315 270 RING		●	■	■	■													
5		375 761 SLEEVE FRONT COVER	(A)		■	■	■													
5		1312 884 SLEEVE FRONT COVER	(B)		■	■	■													
6	74530254	194 414 RING 203X3 MM	(A)	●	■	■	■													
6	74530268	1309 563 RING 203X5 MM	(B)	●	■	■	■													
7		814 876 SCREW M10X50	4 PCS		■	■	■													
8		127 394 WASHER	4 PCS		■	■	■													
9	74530124	388 528 SEAL RING		●	■	■	■													
10	98530011	1121 538 BEARING 76,2X139,7X36,5		■	■	■	■													
11	74530170	1308 366 INPUT SHAFT 25 T.			■	■	■													
12	74530064	315 060 OIL TUBE			■	■	■													
13	98530008	361 043 BEARING 40X85X33,04 MM	OLD TYPE	◆	■	■	■													
14	74530474	358 404 RING		●	■	■	■													
15	74530048	194 484 NUT			■	■	■													
16	74530228	371 687 SYNCHRONIZER CONE			■	■	■													
17	74530348	1756 447 SYNCHRONIZER RING			■	■	■													
18	74530424	369 905 SYNCHRONIZER HUB		■	■	■	■													
19	74530227	369 906 SLIDING SLEEVE	OLD		■	■	■													
19	74530222	1529 939 SLIDING SLEEVE	NEW		■	■	■													
20	74530224	369 908 SYNCHRONIZER CONE			■	■	■													
21	74530220	374 334 CYLINDER ROLLER	4 PCS	●	■	■	■													
22	74530219	369 910 SHIFT STOP	4 PCS		■	■	■													
23	74530218	369 911 SPRING	4 PCS		■	■	■													
24	74530173	365 736 GEAR M/S 4TH 28 T			■	■	■													
25	74530063	194 376 BUSH			■	■	■													
26	98530038	194 413 NEEDLE BEARING 70X78X46 W		●	■	■	■													
27	74530415	264 225 SPACER			■	■	■													
28	74530169	365 735 GEAR M/S 3RD 30 T			■	■	■													
29		352 889 SLIDE			■	■	■													
30	74530282	369 570 FORK		■	■	■	■													
31		1108 255 TIE ROD	(1)		■	■	■													
31		1309 032 TIE ROD	(2)		■	■	■													

Notes / Note :**Continued**

(A-B) TO BE COUPLED TOGETHER

(NOTE A : UP TO GEARBOX 6619486 - NOTE B: FROM GEARBOX 6619487)

(1) UP TO GEARBOX 6618494

(2) FROM GEARBOX 6618495

(3) UP TO GEARBOX 6602911

(4) FROM GEARBOX 6602912

(5) UP TO GEARBOX 6622576

(6) FROM GEARBOX 6622577

(7-8-9) TO BE COUPLED TOGETHER

(*) 74530251-1333 269 NEW STYLE MAINSHAFT

ENABLES FITTING OF 74530252-1333 270 NEW STYLE

SUN GEAR ONLY. 74530116-331 880 OLD STYLE

MAINSHAFT ENABLES FITTING OF BOTH OLD STYLE

74530114-339 800 & NEW STYLE SUN GEAR 74530252-1333 270

(**) 74530215-392 363 PLANET CARRIER CONTAINING M44X1,5 NUT (74170278-387 877)

(***) FOR KIT COMPOSITION SEE END OF GEARBOX SECTION

83

Fig.	Our No.	Part No.	Description	Note	TP	GR 880	GR 880T	GRH 880												
32		194 439	SHIFTING BLOCK			■	■	■												
33		392 993	SPRING			■	■	■												
34		194 441	SLIDE			■	■	■												
35		234 309	SCREW			■	■	■												
36		812 348	RETAINER RING			■	■	■												
37	74530224	369 908	SYNCHRONIZER CONE			■	■	■												
38	74530348	1756 447	SYNCHRONIZER RING			■	■	■												
39	74530226	369 904	SYNCHRONIZER HUB		■	■	■	■												
40	74530227	369 906	SLIDING SLEEVE	OLD		■	■	■												
40	74530222	1529 939	SLIDING SLEEVE	NEW		■	■	■												
41	74530425	365 734	GEAR 2ND 33 T			■	■	■												
42	74530116	331 880	MAIN SHAFT	OLD(*) (5)		■	■	■												
42	74530251	1333 269	MAIN SHAFT	NEW(*) (6)		■	■	■												
43		374 326	OIL TUBE			■	■	■												
44	74530396	365 733	GEAR 1ST 35 T			■	■	■												
45	74530182	381 226	RING			■	■	■												
46	74530183	1340 002	PIN	8 PCS		■	■	■												
47	74530180	383 138	LOCK RING	8 PCS	●	■	■	■												
48	74530181	381 227	SYNCHRONIZER CONE	(7-8)		■	■	■												
48	74530345	1438 526	SYNCHRONIZER CONE	(9)		■	■	■												
49	74530517	1466 318	INTERMEDIATE CONE	(7-8-9)		■	■	■												
50	74530397	373 272	SYNCHRONIZER RING	(7)	◆	■	■	■												
51	74530275	1401 620	SYNCHRONIZER RING	(8)	◆	■	■	■												
51	74530509	1529 950	SYNCHRONIZER RING	(9)		■	■	■												
52	74530186	391 804	RING	(7)	■	■	■	■												
53	74530276	1401 622	RING	(8)	◆	■	■	■												
53	74530508	1533 848	RING	(9)		■	■	■												
54	74530217	383 095	SYNCHRONIZER HUB		■	■	■	■												
55	74530222	1529 939	SLIDING SLEEVE			■	■	■												
56	74530221	395 759	LOCK RING		■	■	■	■												
57	74530223	369 909	SYNCHRONIZER CONE			■	■	■												
58	74530426	365 737	REVERSE GEAR 30 T		■	■	■	■												
59		1108 254	TIE ROD	(1)		■	■	■												
59		1309 031	TIE ROD	(2)		■	■	■												
60		812 319	PLUG Ø 22,00 MM			■	■	■												

Notes / Note :**Continued**

(A-B) TO BE COUPLED TOGETHER

(NOTE A : UP TO GEARBOX **6619486** - NOTE B: FROM GEARBOX **6619487**)(1) UP TO GEARBOX **6618494**(2) FROM GEARBOX **6618495**(3) UP TO GEARBOX **6602911**(4) FROM GEARBOX **6602912**(5) UP TO GEARBOX **6622576**(6) FROM GEARBOX **6622577**

(7-8-9) TO BE COUPLED TOGETHER

(*) **74530251-1333 269** NEW STYLE MAINSHAFTENABLES FITTING OF **74530252-1333 270** NEW STYLESUN GEAR ONLY. **74530116-331 880** OLD STYLEMAINSHAFT ENABLES FITTING OF BOTH **OLD STYLE****74530114-339 800 & NEW STYLE SUN GEAR 74530252-1333 270**(**) **74530215-392 363** PLANET CARRIER CONTAINING M44X1,5 NUT (74170278-387 877)

(***) FOR KIT COMPOSITION SEE END OF GEARBOX SECTION

85

Fig.	Our No.	Part No.	Description	Note	TP	GR 880	GR 880T	GRH 880												
61		294 436	SHIFTING BLOCK			■	■	■												
62		1108 256	TIE ROD	(1)		■	■	■												
62		1309 033	TIE ROD	(2)		■	■	■												
63		392 994	SPRING			■	■	■												
64		315 624	SLIDE			■	■	■												
65		315 626	WASHER			■	■	■												
66		392 995	SPRING			■	■	■												
67		315 628	WASHER			■	■	■												
68		315 629	RETAINER RING			■	■	■												
69		812 348	RETAINER RING			■	■	■												
70	98530021	284 997	BEARING 57X119,9X32,7		■	■	■	■												
71	74530624	284 813	SHIM 0,25 MM		■	■	■	■												
71	74530625	284 814	SHIM 0,30 MM		■	■	■	■												
71	74530626	284 815	SHIM 0,40 MM		■	■	■	■												
72	74530364	294 625	WASHER		■	■	■	■												
73		294 998	LOCK RING			■	■	■												
74	74530114	339 800	SUN GEAR 17 T	OLD(*)		■	■	■												
74	74530252	1333 270	SUN GEAR 17 T	NEW(*)		■	■	■												
75	74530048	194 484	NUT			■	■	■												
76	98530005	374 330	BEARING 50X100X36 MM		■	■	■	■												
77		284 990	LOCK RING			■	■	■												
78	74530168	1308 365	GEAR C/S 5TH 39 T			■	■	■												
79	74530171	368 913	GEAR C/S 4TH 34 T			■	■	■												
80		194 340	WASHER			■	■	■												
81	74530172	368 912	GEAR C/S 3RD 27 T			■	■	■												
82	74530427	368 911	GEAR 2ND 22 T			■	■	■												
83	74530428	372 386	COUNTERSHAFT 15/17 T.			■	■	■												
84		340 430	PIN			■	■	■												
85	98530025	284 992	BEARING 69,8X120X29,79		■	■	■	■												
86	74530473	804 723	RING 119,5X3 MM		◆	■	■	■												
87	74530624	284 813	SHIM 0,25 MM		■	■	■	■												
87	74530625	284 814	SHIM 0,30 MM		■	■	■	■												
87	74530626	284 815	SHIM 0,40 MM		■	■	■	■												
88	74530364	294 625	WASHER		■	■	■	■												
89		294 998	LOCK RING			■	■	■												

Notes / Note :**Continued**

(A-B) TO BE COUPLED TOGETHER

(NOTE A : UP TO GEARBOX 6619486 - NOTE B: FROM GEARBOX 6619487)

(1) UP TO GEARBOX 6618494

(2) FROM GEARBOX 6618495

(3) UP TO GEARBOX 6602911

(4) FROM GEARBOX 6602912

(5) UP TO GEARBOX 6622576

(6) FROM GEARBOX 6622577

(7-8-9) TO BE COUPLED TOGETHER

(*) 74530251-1333 269 NEW STYLE MAINSHAFT

ENABLES FITTING OF 74530252-1333 270 NEW STYLE

SUN GEAR ONLY. 74530116-331 880 OLD STYLE

MAINSHAFT ENABLES FITTING OF BOTH OLD STYLE

74530114-339 800 & NEW STYLE SUN GEAR 74530252-1333 270

(**) 74530215-392 363 PLANET CARRIER CONTAINING M44X1,5 NUT (74170278-387 877)

(***) FOR KIT COMPOSITION SEE END OF GEARBOX SECTION

87

Fig.	Our No.	Part No.	Description	Note	TP	GR 880	GR 880T	GRH 880												
90		194 798	WASHER			■	■	■												
91	98530001	361 044	NEEDLE BEARING		■	■	■	■												
92	74530070	368 921	REVERSE GEAR 21 T.		■	■	■	■												
93		194 400	WASHER			■	■	■												
94		369 569	REVERSE PIN			■	■	■												
95		812 534	SCREW M10X20			■	■	■												
96	74530259	387 300	GASKET		●	■	■	■												
97	74530215	392 363	PLANET CARRIER	(**)		■	■	■												
98		809 831	SCREW M10X50	8 PCS		■	■	■												
99		803 579	PIN 16X35 MM	4 PCS		■	■	■												
100	74530065	234 184	PIN	4 PCS		■	■	■												
101	74530067	234 193	LOCK RING	8 PCS		■	■	■												
102	74530068	254 669	THRUST WASHER	8 PCS		■	■	■												
103	74530069	194 381	BEARING	4 PCS	●	■	■	■												
104	74530046	358 360	IDLE PINION 19 T	4 PCS		■	■	■												
105	74530066	*****	REPAIR KIT			■	■	■												
106	74530047	194 349	RING WHEEL			■	■	■												
107	74530420	284 444	RETAINER RING			■	■	■												
108	74530421	338 867	CARRIER HUB			■	■	■												
109	74530216	1103 707	GEAR DISK			■	■	■												
110	74530422	1101 657	OIL COLLECTOR		■	■	■	■												
111		812 499	SCREW M6X10	3 PCS		■	■	■												
112		807 322	WASHER	3 PCS		■	■	■												
113		194 418	LOCK RING			■	■	■												
114		804 801	SEEGER RING			■	■	■												
115	74530086	284 675	HUB			■	■	■												
116		244 537	SPACER			■	■	■												
117	98530018	244 610	BEARING 75X95X10 MM		■	■	■	■												
118		244 611	LOCK RING			■	■	■												
119	74530013	244 622	SYNCHRONIZER			■	■	■												
120	74530059	333 698	ELASTIC RING			■	■	■												
121	74530058	333 547	DRIVER GEAR	OLD STYLE		■	■	■												
122	74530244	360 627	DRIVER GEAR	NEWSTYLE		■	■	■												
123	74530049	1114 838	HUB			■	■	■												
124	74530059	333 698	ELASTIC RING			■	■	■												

Notes / Note :**Continued**

(A-B) TO BE COUPLED TOGETHER

(NOTE A : UP TO GEARBOX 6619486 - NOTE B: FROM GEARBOX 6619487)

(1) UP TO GEARBOX 6618494

(2) FROM GEARBOX 6618495

(3) UP TO GEARBOX 6602911

(4) FROM GEARBOX 6602912

(5) UP TO GEARBOX 6622576

(6) FROM GEARBOX 6622577

(7-8-9) TO BE COUPLED TOGETHER

(*) 74530251-1333 269 NEW STYLE MAINSHAFT

ENABLES FITTING OF 74530252-1333 270 NEW STYLE

SUN GEAR ONLY. 74530116-331 880 OLD STYLE

MAINSHAFT ENABLES FITTING OF BOTH OLD STYLE

74530114-339 800 & NEW STYLE SUN GEAR 74530252-1333 270

(**) 74530215-392 363 PLANET CARRIER CONTAINING M44X1,5 NUT (74170278-387 877)

(***) FOR KIT COMPOSITION SEE END OF GEARBOX SECTION

89

Fig.	Our No.	Part No.	Description	Note	TP	GR 880	GR 880T	GRH 880												
125		392 933	PLANETARY GEAR HOUSING	(3)		■	■	■												
125	74530423	1303 600	REDUCTION GEAR HOUS.COVER	(4)		■	■	■												
126	74530202	397 406	COMPLETE FORK			■	■	■												
127	74530077	234 017	PIN	2 PCS		■	■	■												
128	74530078	244 437	BEARING	2 PCS	●	■	■	■												
129	74530079	214 075	SPACER	2 PCS		■	■	■												
130	74530080	804 768	SEEGER RING	2 PCS		■	■	■												
131		814 883	SCREW M10X100	2 PCS		■	■	■												
132		127 394	WASHER	2 PCS		■	■	■												
133	74530365	284 015	CYLINDER		■	■	■													
134		815 045	SCREW M12X20			■	■	■												
135		810 983	O-RING			■	■	■												
136		1356 606	PISTON			■	■	■												
137		804 662	O-RING 24,2X3 MM			■	■	■												
138	74120036	811 045	SEAL RING 84,5X3			■	■	■												
139		284 016	INTERMEDIATE PIECE			■	■	■												
140		244 780	BUSH			■	■	■												
141		244 446	O-RING			■	■	■												
142		244 448	WIPER			■	■	■												
143		244 619	LOCK RING			■	■	■												
144		315 553	WASHER			■	■	■												
145		284 455	YOKE BAR			■	■													
145		361 867	YOKE BAR					■												
146		244 541	RING			■	■	■												
147	98530024	194 508	BEARING 75X130X25 MM		■	■	■													
148		315 977	SPACER			■	■	■												
149	74530257	387 302	GASKET		●	■	■	■												
150		315 975	SPEEDOM DRIVE HOUSING			■	■	■												
151		127 394	WASHER	4 PCS		■	■	■												
152		814 878	SCREW M10X60	4 PCS		■	■	■												
153	74530390	174 806	SPEEDOMETER GEAR		◆	■	■	■												
154		151 099	SPACER			■	■	■												
155	74530262	1335 243	SEAL RING (GREEN)	OLD	●	■	■	■												
155	74530035	338 643	OIL SEAL (BROWN)	NEW	●	■	■	■												
156	74170072	1307 760	DUST COVER		■	■	■													

Notes / Note :**Continued**

(A-B) TO BE COUPLED TOGETHER

(NOTE A : UP TO GEARBOX **6619486** - NOTE B: FROM GEARBOX **6619487**)(1) UP TO GEARBOX **6618494**(2) FROM GEARBOX **6618495**(3) UP TO GEARBOX **6602911**(4) FROM GEARBOX **6602912**(5) UP TO GEARBOX **6622576**(6) FROM GEARBOX **6622577**

(7-8-9) TO BE COUPLED TOGETHER

(*) **74530251-1333 269** NEW STYLE MAINSHAFTENABLES FITTING OF **74530252-1333 270** NEW STYLESUN GEAR ONLY. **74530116-331 880** OLD STYLEMAINSHAFT ENABLES FITTING OF BOTH **OLD STYLE****74530114-339 800 & NEW STYLE SUN GEAR 74530252-1333 270**(**) **74530215-392 363** PLANET CARRIER CONTAINING M44X1,5 NUT (74170278-387 877)

(***) FOR KIT COMPOSITION SEE END OF GEARBOX SECTION



Fig.	Our No.	Part No.	Description	Note	TP	GR 880	GR 880T	GRH 880												
157		387 297	GASKET			■	■	■												
158	74170175	338 235	OUTPUT FLANGE	P/PF50		■	■	■												
158		373 825	OUTPUT FLANGE	P/PF60		■	■	■												
159	74170278	1525 988	GROOVED NUT M44X1,5			■	■	■												
160	74530264	164 061	GASKET		●	■	■	■												
161		164 060	COVER	OLD		■	■	■												
161		1313 632	COVER	NEW		■	■	■												
162		394 574	SCREW M10X14	OLD-10 PCS		■	■	■												
162		394 576	SCREW M10X18	NEW-10 PCS		■	■	■												
163		127 394	WASHER	10 PCS		■	■	■												
164		387 756	SHIFTING BLOCK			■	■	■												
165		224 367	OIL FILTER			■	■	■												
166		234 136	RUBBER HOSE			■	■	■												
167		389 007	COVER			■	■													
167		386 395	COVER					■												
168	74530258	387 314	GASKET		●	■	■	■												
169	<i>98530010</i>	1548 819	CONE 85 MM	NEW TYPE	■	■	■	■												
170	<i>98530009</i>	1548 818	NEEDLE BEARING 40X33,04	NEW TYPE	■	■	■	■												
171	74530279	*****	REPAIR KIT			■	■	■												
172	74530470	550 535	GASKET KIT	(***)	●	■	■	■												
172	74530471	550 538	GASKET KIT	(***)	●	■	■	■												
173	74530475	550 536	GASKET KIT	(***)	●	■	■	■												
174	74530040	194 838	OIL PUMP			■	■	■												
175	74530277	*****	SYNCHRO RING ASSY	OLD(8)		■	■	■												
175	74530513	*****	SYNCHRO RING ASSY	NEW(9)		■	■	■												

Notes / Note :

- (A-B) TO BE COUPLED TOGETHER (NOTE A : UP TO GEARBOX **6619486** - NOTE B: FROM GEARBOX **6619487**)
- (1) UP TO GEARBOX **6618494**
- (2) FROM GEARBOX **6618495**
- (3) UP TO GEARBOX **6602911**
- (4) FROM GEARBOX **6602912**
- (5) UP TO GEARBOX **6622576**
- (6) FROM GEARBOX **6622577**
- (7-8-9) TO BE COUPLED TOGETHER
- (*) **74530251-1333 269** NEW STYLE MAINSHAFT ENABLES FITTING OF **74530252-1333 270** NEW STYLE SUN GEAR ONLY. **74530116-331 880** OLD STYLE MAINSHAFT ENABLES FITTING OF BOTH **OLD STYLE** **74530114-339 800** & **NEW STYLE** SUN GEAR **74530252-1333 270**
- (**) **74530215-392 363** PLANET CARRIER CONTAINING M44X1,5 NUT (74170278-387 877)
- (***) FOR KIT COMPOSITION SEE END OF GEARBOX SECTION

